



THE PERFECT FIT

GEITH QUICK COUPLER

Proven, durable
and trusted
for generations



www.geith.com

GEITH COUPLER

► Achieve premium site safety and productivity with the industries number one coupler from Geith

We strongly believe in designing and manufacturing couplers that offer the perfect fit with your excavator. Geith couplers are manufactured specifically to your excavator model to ensure optimum bucket rotation and digging power.

With over 50 year's experience, our manufacturing control and process excellence, combined with highly experienced production and design teams, utilise only the best in high strength steels to achieve consistent quality resulting in superior product performance and durability

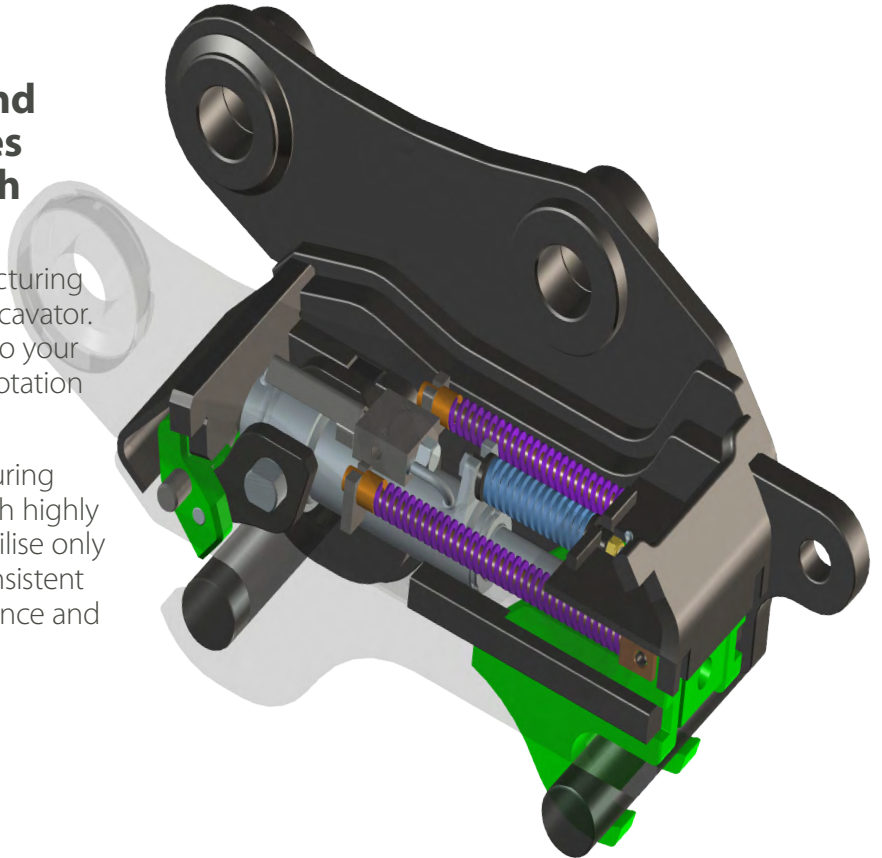

Features & Benefits: **DURABILITY**

- Our simple design has no greasing requirements, less maintenance and replacement parts which guarantee you a hassle free coupler
- Manufactured using extra high strength steel to increase durability while optimizing weight to enhance excavator performance



SAFETY

- Front safety lock **a** is forced on by spring **b** which retains the attachment in case of misconnection
- The rear safety lock **c** is the secondary safety feature backed up by two powerful springs **d** which retains the attachment rear pin in case of cylinder failure
- Powerful spring activated safety locks work in all dirty environments unlike gravity systems
- Geith patented "curl to release" control system guarantees the attachment is only released in a safe position (see using the geith coupler)



► **Simple, Proven Design with low Maintenance**

Using the Geith Coupler:

1. Hook the bucket
2. Curl to safe position
3. Front lock closes
4. Engaging plate extends

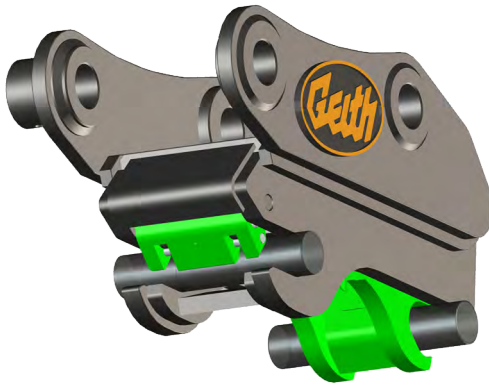
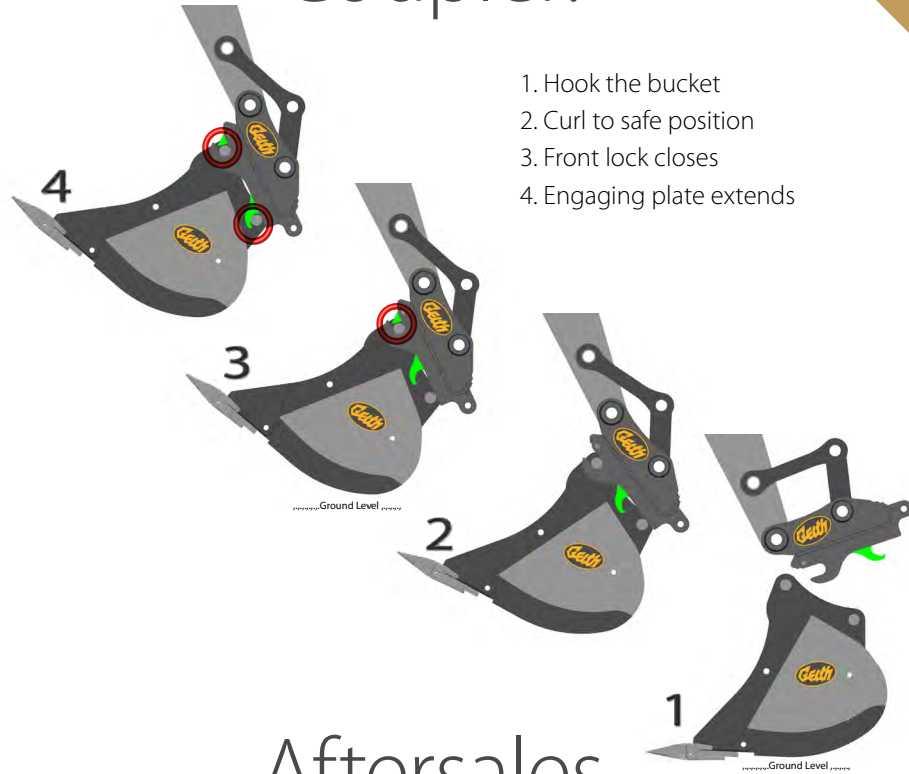

Aftersales & Parts:

Geith peace of mind

Geith has exceeded customer expectations by constantly manufacturing products with unmatched durability, superior performance and suitability, extended service life and high return on investment – With a strong vision for the future, Geith is a name you can trust for years to come.

Full support on spare parts

At Geith, we understand that easy servicing and maintaining couplers is important to our customers. Therefore, we focus on our design on making parts more accessible keeping maintenance time to a minimum

We carry an extensive range of all coupler replacement parts and can ship overnight to minimize downtime

Fast & easy installation

- We provide custom engineered hydraulic kits for all models of excavators with all the parts required for complete installation
- Easy installation with step-by-step guide

VERSATILITY

- Variable pin centre design allows you to easily pick up and swap the widest range of OEM attachments. (see technical specifications)
- Ability to reverse buckets  to allow the operator to excavate against walls and under pipes
- Mechanical couplers can easily be upgraded to Hydraulic

PRODUCTIVITY

- A geith coupler can save you 25% of total machine operating time compared to direct mount
- Operator can change attachment from the comfort and security of their cab
- A more compact design means improved tip radius which increases breakout force





Technical Specifications:

Excavator Weight (Tons)	Pin Diameter (mm)	Coupler Model (H) Hydraulic (M)Manual	Min - Max Centres (mm)	Base Width (mm)	Coupler Weight kg (lbs)
2 - 4	35/40	QC35-40 H*	130-214	122	35(77)
3 - 5	40	QH40 (H) (M)	220-355	150	65(143)
5 - 7	45	QC45H	218-394	144/150	63(139)
5-7	45	QH45M	220-395	150	65(143)
6-9	50	QC50H	235-375	160/180	72(159)
6-9	50	QH50M	234-385	150/180	65(143)
7-11	55	QH55 (H) \ (M)	275-316	168/180	82(180)
7-11	60	QH60H	288-302	168	95(209)
11-17	60	QH60M	280-480	250	172(379)
11-17	60	QC60H	280-480	210/250	150(330)
11-15	65	QC65H	355-430	220/250	171(379)
11-15	65	QH65M	355-420	220/250	177(390)
15-22	70	QH70 (H) (M)	365-490	250/280	186(410)
16-29	80	QC80H	385-530	280/300	285(628)
16-29	80	QH80M	390-525	280-300	240(529)
24-35	90	QC90H	380-570	320	420(924)
24-35	90	QH90 (M)	460-610	325	436(961)
30-40	100	QH100 (H) (M)	500-630	370	721(1,589)
33-46	110	QH110 (H) (M)	565-645	390	721(1,589)
45-60	115	QH115H	608-685	438	1090(2,402)
50-65	120	QH120H	570-635	428/468	1090(2,402)
65-70	130	QC130H	615-790	487/527	1460(3,217)
70-87	140	QC140H	667-785	527	1623(3577)

*Lifting eye is optional

We also offer the MPL coupler series, all manual with a different mechanism than the QC and QH Series

Excavator Weight (Tons)	Pin Diameter (mm)	Coupler Model	Min - Max Centres (mm)	Base Width (mm)	Coupler Weight kg (lbs)
1.2-2.5	30	MX30MPL	104-201	102	13(29)
2-4	35	MX35MPL	125-245	122	26(57)
3-5	40	MX40MPL	170-350	122	40(88)
5-7	45	MX45MPL	220-360	140/150	53(117)

US - Geith Inc
 2905 Shawnee Industrial Way, Suwanee, GA 30024 T: 800-762-4090
 (Toll Free) F: 866-472-4950
 E: ussales@geith.com
 www.geith.com

Geith also offer a wide range of attachments and spare parts:



www.geith.com

